

2 in 1 Controller (Matter Over WiFi+2.4GHz)

Model No.: SM2

Feature

- Certified Matter Over Wifi, Matter standard protocol, support to Collaborate with multi platforms
- Wide compatibility, collaborate with products from different brands which comply with Matter ecosystem
- Simple configuration, easily pairing via QR code
- Voice control, compatible with Siri, Google Assistant & Alexa portable control
- Max work with 12pcs remote control (distance 30m)
- Auto transmitting: transmit signal to another one automatically and extend countless distance
- Support DND mode, usually used in power failure area to save power
- Support multi platforms like Apple Home Kit, Amazon Alexa, Google Home, SmartThings, Tuya smart



Parameters

Product Name:	2 in 1 Controller (Matter Over WiFi+2.4G)	IP Rate:	IP20
Model No.:	SM2	Working Temperature:	-10~40°C
Input Voltage:	DC12~24V	EMC Standard (EMC):	ETSI EN 301 489-1 V2.2.3 ETSI EN 301 489-3 V2.1.1
Output Current:	12A/单通道	Safety Standard(LVD):	EN 61347-2-11: 2001+A1: 2019 EN 61347-1: 2015+A1: 2021 EN 62493: 2015+A1: 2022
Total Output:	Max 12A	Radio Equipment(RED):	ETSI EN 300 440 V2.2.1
Protocol:	WiFi+2.4G RF	Certification:	CE, EMC, LVD, RED
WiFi Standard:	IEEE 802.11b/g/n 2.4G Hz		
Control Distance: RF:	30M		

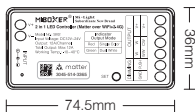

Connection Diagram

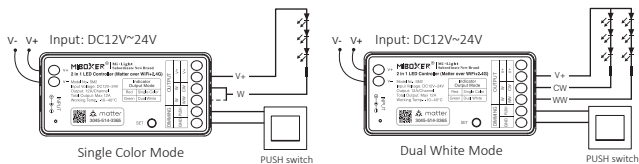

Application Diagram

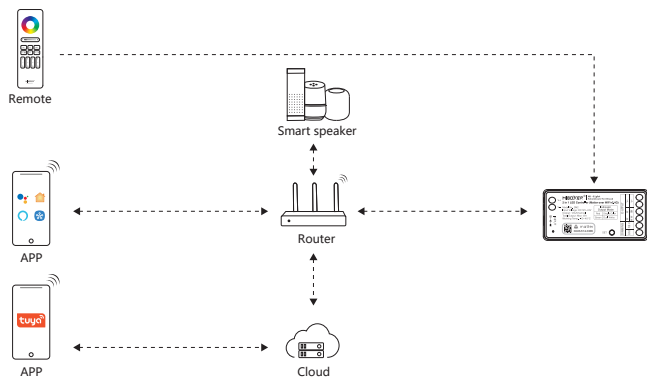

PUSH Dimming

Short press PUSH switch:

Turn ON/OFF light

Long press PUSH switch:

- Stepless dimming brightness.
- Long press and release your finger, then repeat long pressing to increase or decrease brightness.

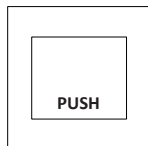

Setting Output Mode

Output mode is related with connected led lights

Solution: short press " SET " to switch mode (attention: it will step out automatically without any operation within 3 seconds)

Output Mode table sheet (indicator Color means correct output mode)

Indicator color	Red Light	Green Light
Output	Single Color Mode	Dual White Mode

2.4G RF Remote control instruction

Linking Code Instructions

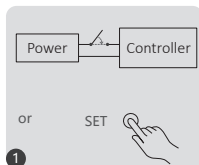

Power off 10 seconds and power on again or short press " SET " one time

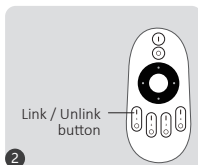

Short press " I " button 3 times within 3 seconds.

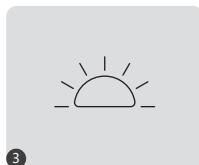

Lights blink 3 times slowly means linking is done successfully.



Linking failed if light is not blinking slowly, Please follow above steps again.
(Note: Light that have linked can't link again)

Unlinking Code Instructions

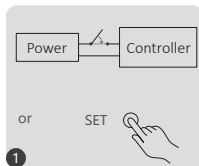

Power off 10 seconds and power on again or short press " SET " one time

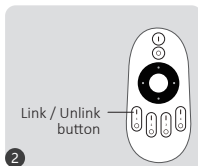

Short press " I " button 5 times within 3 seconds.

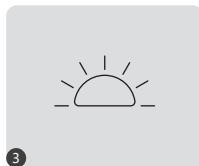

Lights blink 10 times quickly means unlinking is done successfully.



Unlinking failed if light is not blinking quickly, Please follow above steps again.
(Note: Light haven't linked that don't need to unlink)

Auto transmitting & Synchronization (only for remote control)

Remote signal auto transmitting

One light can transmit the signals from the remote control to another light within 30m, as long as there is a light within 30m, the remote control distance can be limitless.

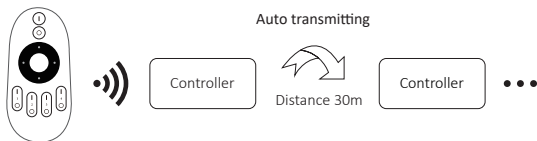

Turn Do Not Disturb mode on and off (ON by default)

Turn on "Do Not Disturb" (applicable to areas with frequent power outages to save energy)

Turn on Do Not Disturb mode:

Short press the "OFF" button 3 times within 3 seconds, and then short press the "ON" button 3 times. The light flashes 4 times to indicate success.

Note: When the lamp is powered on again after a power outage, its status (lights on or off) will remain the same as before the power outage.

Turn off Do Not Disturb mode:

Short press the "ON" button 3 times within 3 seconds, and then short press the "OFF" button 3 times. The light flashes 4 times slowly to indicate successful shutdown.

Note: When the lamp is powered on again after a power outage, its status will be on by default.

Compatible with these 2.4G RF remote controls (Purchased separately)



C2



C3



FUT006



FUT007



B1 / B1-B / T1



B2 / T2



K1 / K1-B



K2 / K2-B



FUT087
FUT087-B



S1-B / S1-W
S1-G



WL-Box2

App control instructions

Pairing Network (5G router is unavailable)

For other Matter network configuration methods,
please refer to the network configuration guide

1). Download and install "Tuya Smart" APP

Search "Tuya Smart" in application store or Scan QR
code

Please register account for first operation, login
into APP if you already had account.



2). Pairing Network

1). Connect controller with mains

2). Checking indicator status (quick flashing 2 times per seconds)

There are 2 solutions if indicator status not flash quickly

-Long press " Link" 3 seconds

-Power off and power on controller 6 times

3). Connect phone with home wifi

4). Open Tuya APP, click "+" and "scan"

5). Scan QR code on product

6). Complete configuration

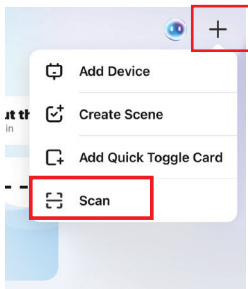

*For more distribution network options,
please refer to the distribution guide!

Alexa voice control instruction

Please add device into **[Tuya Smart]** app, then start following steps

- 1). Open Alexa App
- 2). Click “More” on the bottom of right corner
- 3). Click “Skills & Games”

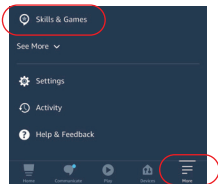

- 4). Click “Q” on the top of right corner
- 5). Type into “Smart life” and search



- 6). Click “Smart Life” skill, follow instruction to finish configuration and start voice control

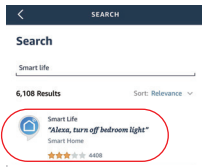

Google Home voice control instruction

Please add device into **[Tuya Smart]** app , then start following steps

- 1). Open Google Home App
- 2). Click “+” on the top of left corner

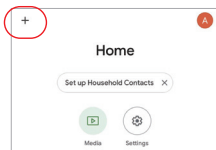

- 3). Click “Set up device”

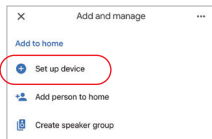

- 4). Click “Works with Google”

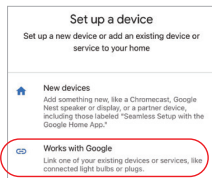

- 5). Click “Q” on the top of right corner
- 6). Type into “Smart life” and search
- 7). Click “Smart Life” skill, follow instruction to finish configuration and start voice control

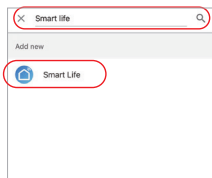

Attention

1. Please turn off power supply before installation.
2. Please ensure input voltage to be same as requirements from device.
3. Don't disassemble device if you are not expert, otherwise it will damage it.
4. Please do not use the light in the place with widely range metal area or strong electromagnetic wave nearby, otherwise, the remote distance will be seriously affected.



Made in China